

News from:

ROCKY MOUNTAIN MENNONITE CAMP



709 County Road 62
Divide, CO 80814

719-687-9506
info@rmmc.org
www.rmmc.org

March 2017

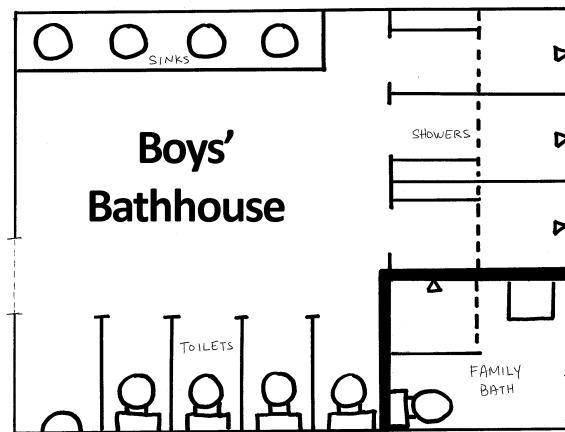

BOYS' BATHHOUSE RENOVATION

The Vision 2020 Capital Program is moving ahead to other needs of the Rocky Mountain ministry. In addition to the Pleiades facility rebuilding (now being greatly enjoyed), the boys' bathhouse on the Chapel side of camp is the next structure identified for replacement.

Taking into consideration a variety of factors, the camp board of directors has decided to renovate (instead of replace) the boys' bathhouse, for the following reasons:

1. The time needed to raise funds and install a new septic system on the Chapel side (no building permits for new construction can be obtained before a septic system is in place). Estimated cost \$175,000.
2. The time needed to raise funds and build a new bathhouse. Estimated cost \$200,000.
3. The current feedback from campers, guests and volunteers for needed improvements to the boys' bathhouse soon, not in 3-4 years.
4. The appreciation (and expectation) for sleeping facilities with indoor restrooms versus a walk to an area bathhouse. Why build a new bathhouse if cabins with indoor bathrooms are the desire for the future? The decision to renovate the interior of the boys' bathhouse at this time addresses these current realities.

The bathhouse will receive the same finishes as the Eiger bathhouse (changing space as part of each shower, new sinks, wider toilet stalls, and new partitions). A family bathroom will be also added with a separate entrance and will include a shower, toilet, and sink. This will take the space of the old changing area in the boys' bathhouse. The estimated cost for renovation is \$30,000.

Work is already underway to ensure the bathhouse will be ready to go for the summer camping season! We need help to meet the completion goal! Please sign up to volunteer and/or donate online at www.rmmc.org or contact RMMC by phone (719-687-9506) or email (info@rmmc.org).

Visit RMMC's [Facebook page](#) to see photos of the renovation and progress.



WHO'S BEEN HELPING

Thank you to all the volunteers that have helped at camp in the month of February.

Caleb Bay
Frank & Mary Ellen Gaeddert
Anita Goertzen
Dennis LeFevre
Caleb Longenecker
Hans Miller
Dave Miller
Ed Shirk
Jeff, Jean, and Ethan Spicher
Bill Unruh
Lyonell Unruh
Marie Voth
Service Adventure - Colorado Springs Unit



Pictured: Marie Voth, Jeff Spicher, and Jean Spicher help prepare food during Young Adult Snow Camp.



YOU'VE BEEN SPOTTED!

Larry and Margaret Goering of Newton, KS and their daughters, Suzie Schultz of Olathe, KS (far right) and Sandy Hiebert of Whitewater, WI (far left) and niece, Stephanie Hiebert were spotted wearing their RMMC shirts at a hacienda in Obraje, Mexico. The travelers spent time in Mexico in August visiting the sites where Larry and Margaret had lived and done service work with MCC from 1968-1970. Thanks, Larry, Margaret, Suzie, Sandy, and Stephanie, for sharing RMMC with Mexico! Share your "spotted" photo with us! Email it to jenelle@rmmc.org.



MARK YOUR CALENDARS

- **April 20-23**
 - Spring Mennonite Quilters Retreat
- **May 26-29**
 - Memorial Day Work & Play Retreat
- **June 4-10**
 - Colorado Roots Music Camp (guest group) - Kitchen volunteers needed!
- **June 11-17**
 - Sr High Resident / 6&7 Wilderness I camps
- **June 18-24**
 - Grade 8&9 Resident / 6&7 Wilderness II camps
- **June 25-July 1**
 - Grade 6&7 Resident / 8&9 Wilderness I camps
- **July 2-8**
 - Grade 4&5 Resident / 8&9 Wilderness II camps
- **July 21-23**
 - Grade 3 Resident camp
- **July 23-28**
 - Family Camp I
- **July 23-29**
 - Sr High Wilderness I Camp
- **July 30-August 4**
 - Family Camp II
- **July 30-August 5**
 - Sr High Wilderness II Camp



Register
Online



MAKE A RESERVATION

Dates listed represent available nights for ridge cabin accommodations. Please call to verify availability. To see photos of the cabins visit our [Ridge Cabin Facilities page](#).

MARCH 2017

[Eagle's Nest](#): 1-14, 17-21, 26-31

[Sky-Hi-View](#): 1-31

[Rocky Ridge](#): closed for winter

[Solitude Center](#): 1-3, 5-16, 19-31

[Emmental](#): 1-2, 5-9, 12-23, 26-31

APRIL 2017

[Eagle's Nest](#): 1-13, 17-30

[Sky-Hi-View](#): 1-13, 17-30

[Rocky Ridge](#): closed for winter

[Solitude Center](#): 1-13, 17-23, 26-30

[Emmental](#): 1-13, 17-19, 23-30

MAY 2017

[Eagle's Nest](#): 1-16, 21-26, 29-31

[Sky-Hi-View](#): 1-18, 21-23, 29-31

[Rocky Ridge](#): closed for winter

[Solitude Center](#): 1-31

[Emmental](#): 1-26, 29-31

VOLUNTEER 
sign up online through Sign Up Genius

COME VOLUNTEER

There are always projects to complete here at camp that need volunteer hands. If you have interest in helping out, give us a call, send us an email, or check out Sign Up Genius website to see where you can fit in.



Sign Up
for E-News

READ ABOUT RMMC

In addition to the monthly newsletter, a seasonal Trail Call is also published. To be on the email list to receive that publication, sign up using the link on the left.

Follow Us



Rocky Mountain Mennonite Camp
709 County Road 62
Divide, CO 80814

Update your [Email Preferences](#) or [Unsubscribe](#)